

Attachment A

Annexation Legal Description:

In Section: 22 Township: 85 Range: 23, Unincorporated Story County, Iowa: the West 750' of the North 650' in the Northeast of the Southeast & the East 284' of the North 650' in the Northwest of the Southeast

Attachment B

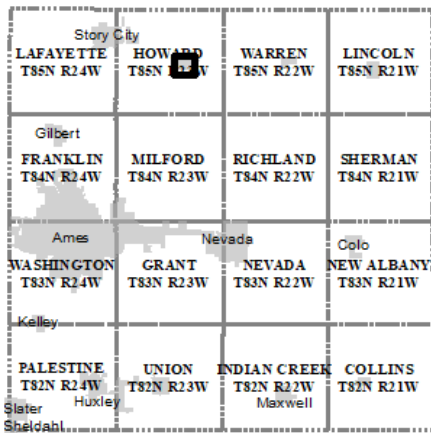
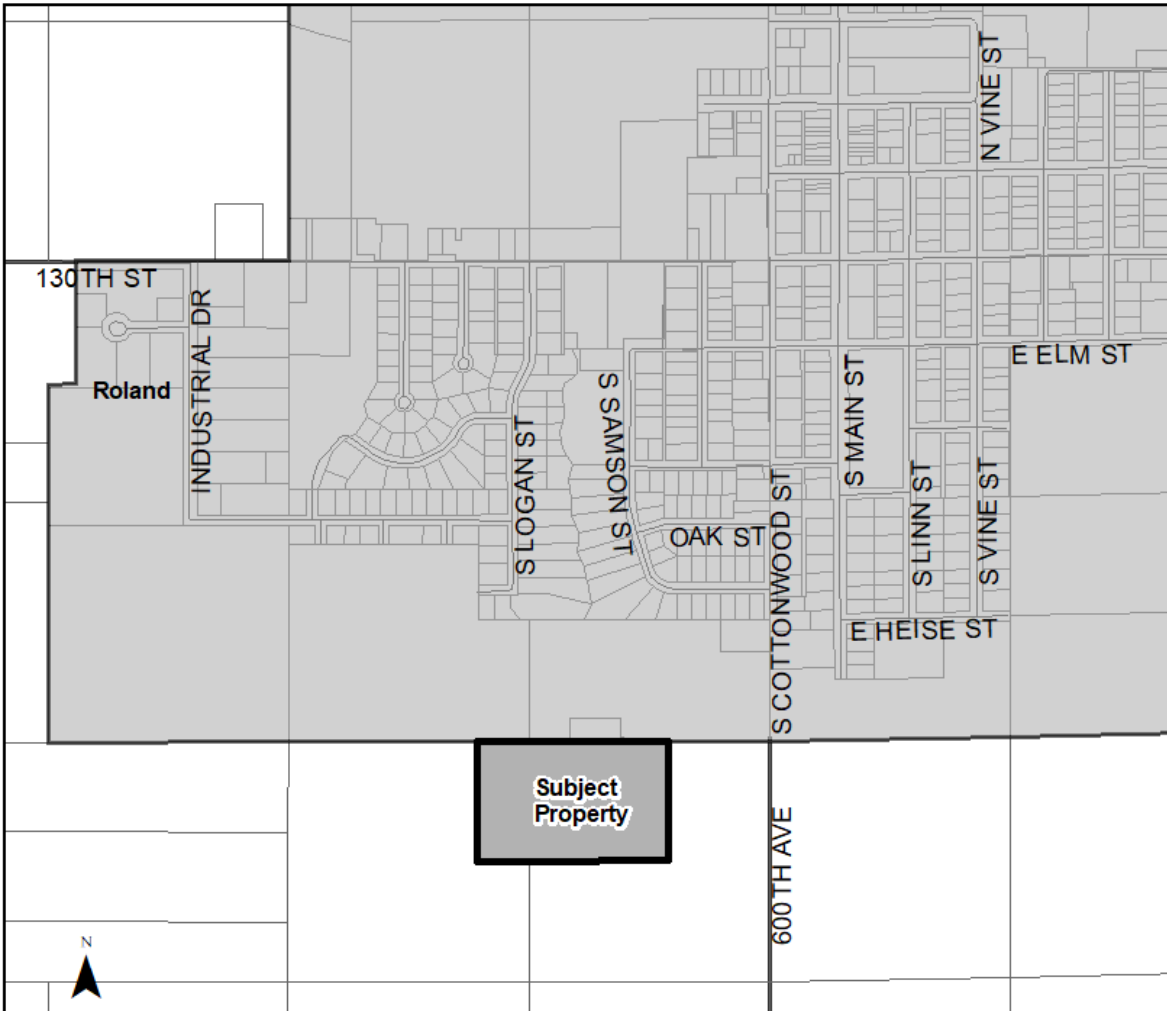

**City of Roland
Voluntary Annexation
Parcel #02-22-400-210**

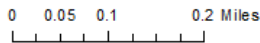
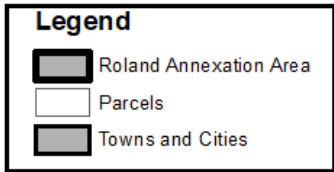

DISCLAIMER:
Story County's digital cadastral data is a representation of recorded plats and surveys for use within the Geographical Information System for the purpose of data access and analysis. These and other digital data do not replace or modify land surveys, deeds, and/or other legal instruments defining land ownership or use.

Map created on 3/16/2023
by the Story County Planning and Development Department.